

**HARYANA POLICE HOUSING CORPORATION, PANCHKULA**

**PROJECT :**  
STANDARD DESIGN FOR 3 STOREYED TYPE-I ROW TYPE HOUSES

**SCHEDULE OF JOINERY**

S.NO	TYPE	SIZE	CILL	TOP
1.	DG	6'-0"X8'-9"	---	8'-9"
2.	DG1	5'-6"X8'-9"	---	8'-9"
3.	D	3'-6"X8'-9"	---	8'-9"
4.	D1	3'-3"X7'-0"	---	7'-0"
5.	D3	2'-3"X7'-0"	---	7'-0"
6.	W	4'-6"X6'-3"	2'-6"	8'-9"
7.	W1	4'-6"X5'-3"	3'-6"	8'-9"
8.	W2	2'-0"X3'-9"	5'-0"	8'-9"

**COVERED AREA**

AREA OF ONE UNIT = 550 S.FT  
AREA OF BALCONY = 112 S.FT  
AREA OF STAIR CASE = 97 S.FT

TOTAL AREA = 759 S.FT

**THIS DRAWING HAS BEEN APPROVED BY CMD ON DATED: 14-12-16.**

**GENERAL NOTES:**

- THESE DRGS. ARE THE PROPERTY OF HPHC AND MUST NOT BE ALTERED COPIED OR USED IN WHOLE OR IN PART THEREOF WITHOUT THE PERMISSION OF THE AUTHORITY IN WRITING.
- ENGINEER AND CONTRACTOR MUST VERIFY ALL DIMENSIONS BEFORE EXECUTION OF WORK.
- SPECIFICATIONS TO BE FOLLOWED AS APPROVED BY THE COMPETENT AUTHORITY.
- PROVISION OF FIRE FIGHTING SHALL BE AS PER NBC AND SATISFACTION OF LOCAL FIRE AUTHORITIES.
- SOLAR WATER HEATING SYSTEM AS PER HARYANA GOVT. NOTIFICATION.
- RAIN WATER HARVESTING SYSTEM AS PER HARYANA GOVT. NOTIFICATION.
- WRITTEN DIMENSIONS ARE TO BE FOLLOWED ONLY.
- IN CASE OF ANY DOUBT PLEASE, REFER TO ARCHITECTURE BRANCH FOR CLARIFICATION.

**M.D.:**

**CHIEF ENGINEER:** \_\_\_\_\_ **CHIEF ARCHITECT:** \_\_\_\_\_

**ARCHITECT:** \_\_\_\_\_ **SENIOR ARCHITECT:** \_\_\_\_\_

**SCALE:** N.T.S. **DATE:** \_\_\_\_\_

**DEALT BY:** PRIYANKA **CHECKED BY:** \_\_\_\_\_

**DWG NO.:** 1 **JOB NO.:** 1091

**TITLE:**  
GROUND FLOOR PLAN

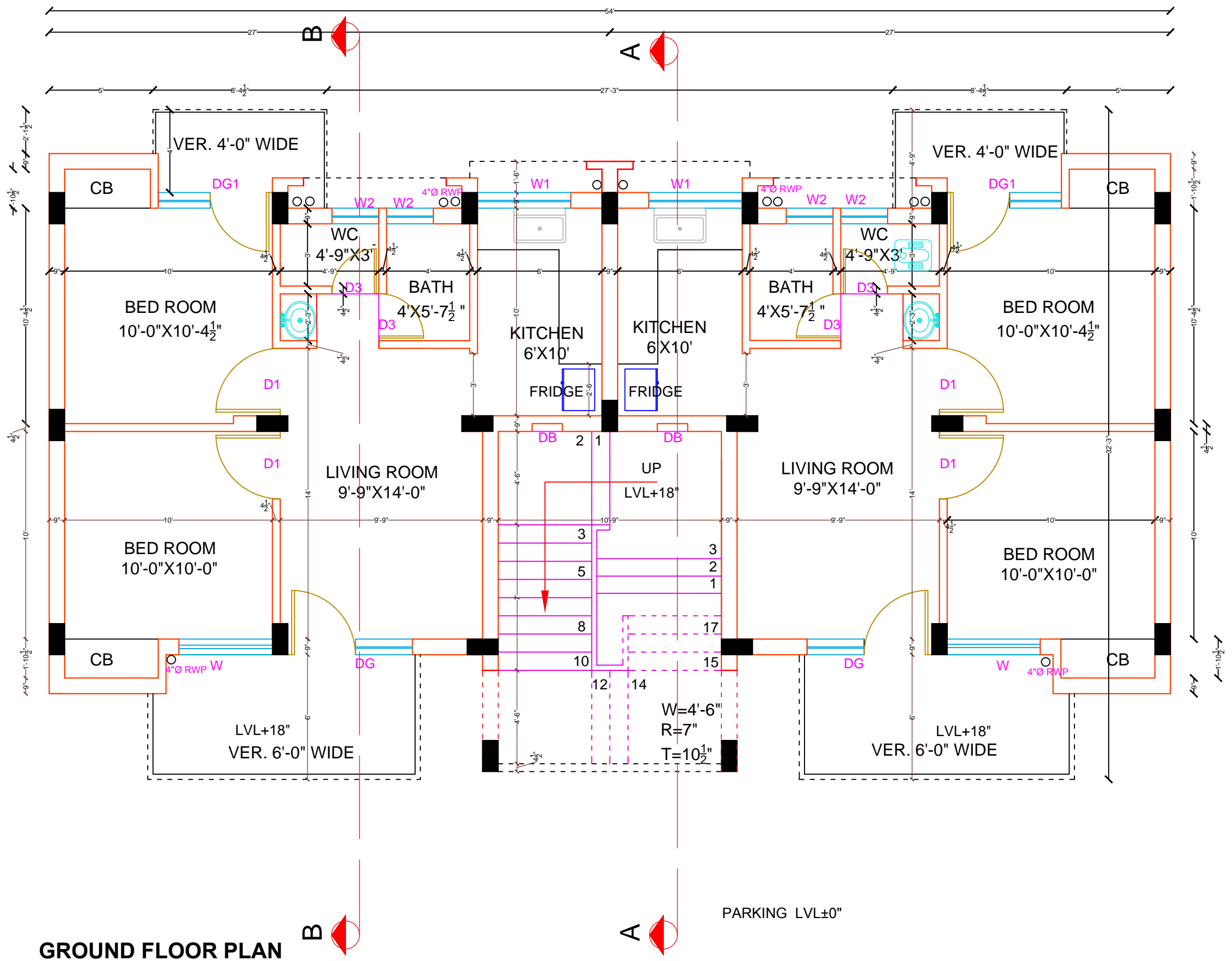

**GROUND FLOOR PLAN**

PARKING LVL±0"